

# THE JAMES WALKER CO.

## PEERLESS CHAIN

### Accoloy® Eye Type Foundry Hooks

#### Specifications

Stock Number	Size of Chain		WLL Lbs.	Wt. Each Lbs.	D In.	E In.	F In.	G In.	J In.	K In.	Spherical Radius In.
	In.	mm									
592454498	9/32	7	4,300+++	2.0	4-3/4	2-5/8	5/8	1	1-9/16	1-1/8	1/4
592454499	3/8	10	8,800+++	4.1	5-3/4	3-1/8	13/16	1-1/4	1-7/8	1-3/8	5/16
592454500	1/2	13	15,000+++	7.0	6-7/8	3-3/4	1-1/32	1-1/2	2-1/4	1-5/8	3/8
592454501	5/8	16	22,600+++	10.5	8-1/16	4-1/4	1-1/4	1-3/4	2-5/8	1-7/8	7/16
592404502	3/4	20	28,300++	18.2	9-1/4	4-3/4	1-1/2	2	3	2-1/8	1/2
592404503	7/8	22	34,200++	26.0	10-3/8	5-1/4	1-3/4	2-1/4	3-3/8	2-3/8	9/16
592404504	1	26	47,700++	35.0	11-9/16	5-3/4	2	2-1/2	2-3/4	2-3/4	5/8
592404505	1-1/4	32	72,300++	50.0	12-3/4	6-3/8	2-1/4	3	4-1/4	3-1/4	3/4

†† Values shown for these sizes are Grade 80. ††† Values shown for these sizes are Grade 100.

Accoloy® Eye Type Foundry Hooks

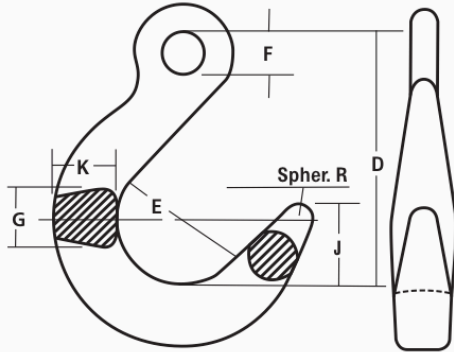

Kuplex® II Clevis Type Foundry Hooks

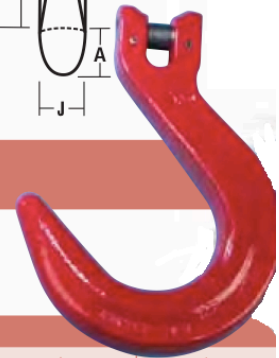
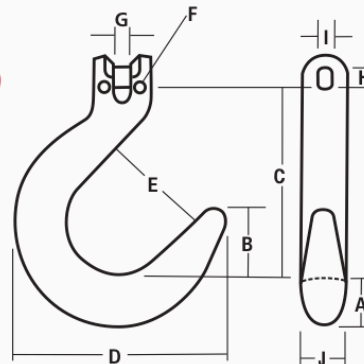

### Kuplex® II Clevis Type Foundry Hooks

Kuplex II Foundry hooks when properly used are designed for maximum service such as those applications encountered in foundry work. The throat of the hook is designed to accommodate standard trunnions. The tip of the hook is designed for ease of insertion into holes in the casting.

#### Specifications

Stock Number	Hook No.	Size of Chain		WLL Lbs.	A In.	B In.	C In.	D In.	E In.	F In.	G In.	H In.	I In.	J In.	Wt. Each Lbs.
		In.	mm												
598250498	K-498	9/32	7	4,300+++	1-1/8	1-9/16	4-7/16	4-7/8	2-5/8	1/8	5/16	13/32	11/32	7/8	2.1
598250499	K-499	3/8	10	8,800+++	1-3/8	1-7/8	5-1/2	5-7/8	3	5/32	7/16	9/16	15/32	1-1/8	4.3
598250500	K-500	1/2	13	15,000+++	1-1/2	2-1/4	6-5/8	6-7/8	3-7/8	3/16	9/16	3/4	21/32	1-1/2	8.2
598250501	K-501	5/8	16	22,600+++	2-3/16	2-9/16	7-5/8	8-9/32	4-1/8	1/4	11/16	15/16	13/16	1-3/4	14.4
598200502	K-502	3/4	20	28,300++	2-3/4	3	8-13/16	9-5/8	4-13/16	5/16	13/16	1-7/32	1	2	24.5
598200503	K-503	7/8	22	34,200++	3	3-3/8	9-15/16	10-11/16	5-3/8	3/8	15/16	1-9/32	1-1/16	2-1/4	33.1

†† Values shown for these sizes are Grade 80. ††† Values shown for these sizes are Grade 100.

**WARNING: DO NOT EXCEED RATED CAPACITIES**