

THE JAMES WALKER CO.

CROSBY GRAB HOOKS

H-330 / A-330



- Forged Steel - Quenched and Tempered.
- Design factor is 4:1.
- Features quick and easy assembly.
- H-330 designed for Crosby Spectrum 4® chain.
- A-330 designed for Crosby Spectrum 7® chain.

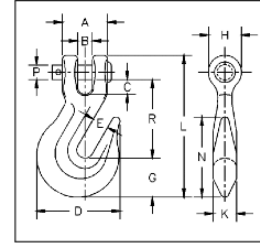

H-330 / A-330 Clevis Grab Hooks

Chain Size (in.)	Stock No.		Working Load Limit (lbs.)		Weight Each (lbs.)	Dimensions (in.)											
	H-330 Carbon	A-330 Alloy*	H-330 Carbon	A-330 Alloy		A	B	C	D	E	G	H	K	L	N	P	R
1/4	1027105	1027249*	2600	3500	.36	1.00	.32	.31	1.81	.34	.88	.72	.47	3.05	1.75	.31	1.64
5/16	1027123	1027267*	3900	4700	.62	1.22	.43	.36	2.12	.44	.97	.91	.59	3.66	2.06	.38	2.02
3/8	1027141	1027285*	5400	7100	1.00	1.42	.48	.49	2.53	.50	1.17	1.00	.72	4.42	2.34	.44	2.41
7/16	1027169	1027301	7200	8750	1.31	1.66	.66	.62	3.09	.56	1.31	1.13	.69	4.94	2.66	.56	2.75
1/2	1027187	1027329*	9200	12000	2.22	1.88	.57	.51	3.56	.66	1.53	1.25	.78	5.72	2.97	.63	3.19
5/8	1027203	1027347	13000	18100	4.41	2.31	.71	.67	4.39	.78	1.78	1.56	1.09	6.83	4.31	.75	4.09
3/4	1027221	1027365	20200	24700	6.50	2.62	.94	.94	5.22	.94	2.13	1.88	1.31	8.13	5.09	.88	4.63

* These A-330 hooks are forged with an "8" designating Grade 80, and are suitable for use with Grade 8 chain in over head lifting applications as long as hook is Proof Tested as part of the chain sling assembly or as an individual component per ANSI B30.9c. We recommend the use of the A-338 which is proof-tested and supplied with a proof test certificate.

H-323 / A-323



- Forged Steel - Quenched and Tempered.
- Design Factor is 4:1.
- H-323 designed for Crosby Spectrum 4® chain.
- A-323 designed for Crosby Spectrum 7® chain.

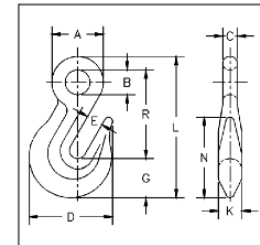

H-323 / A-323 Eye Grab Hooks

Chain Size (in.)	Stock No.		Working Load Limit (lbs.)		Weight Each (lbs.)	Dimensions (in.)										
	H-323 Carbon	A-323 Alloy*	H-323	A-323		A	B	C	D	E	G	K	L	N	R	
1/4	1026204	1026384*	2600	3500	.28	1.09	.53	.31	1.81	.34	.88	.47	3.05	1.75	1.88	
5/16	1026222	1026400*	3900	4700	.45	1.31	.62	.38	2.12	.44	.97	.59	3.59	2.06	2.28	
3/8	1026240	1026428*	5400	7100	.79	1.56	.75	.44	2.53	.50	1.17	.72	4.28	2.34	2.69	
1/2	1026286	1026464*	9200	12000	1.75	1.94	.88	.53	3.56	.66	1.53	.78	5.44	2.97	3.38	
5/8	1026302	1026482*	13000	15800	3.25	2.38	1.06	.66	4.41	.78	1.89	1.00	6.66	3.78	4.11	
3/4	1026320	1026507	20200	24700	5.94	2.88	1.38	.75	5.22	.94	2.13	1.31	8.06	5.09	5.16	

* These A-323 hooks are forged with an "8" designating Grade 80, and are suitable for use with Grade 8 chain in over head lifting applications as long as hook is Proof Tested as part of the chain sling assembly or as an individual component per ANSI B30.9c. We recommend the use of the A-328 which is proof-tested and supplied with a proof test certificate.

BL-GRB



Bullard Alloy Grab Hook with Latch

- Dimensions shown relate to H-323 / A-323 drawing scheme shown above.

Chain Size (in.)	BL-GRB Stock No.	Working Load Limit (lbs.)*	Weight Each (lbs.)	Dimensions (in.)										
				A	B	C	D	E	G	K	L	N	R	
1/4	1051904	3500	.50	1.25	.56	.28	2.47	.40	.86	.53	3.68	2.18	2.50	

* Ultimate Load is 4 times the Working Load Limit.

WARNING: DO NOT EXCEED RATED CAPACITIES

THE JAMES WALKER CO.

CROSBY SLIP HOOKS

H-331 / A-331



- Forged Carbon Steel or Forged Alloy Steel - Quenched and Tempered.
- All pins are Alloy Steel - Quenched and Tempered.
- **Not Suitable for use with Grade 80 chain and chain slings used in overhead lifting.** For slings or lifting chains, Grade 80 or 100 alloy components are recommended.

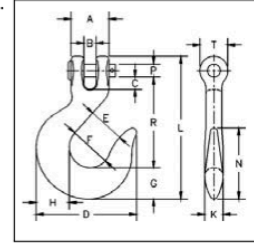

H-331 / A-331 Clevis Slip Hooks

Chain Size (in.)	Stock No.		Working Load Limit (lbs.)*		Weight Each (lbs.)	Dimensions (in.)													
	H-331 Carbon	A-331 Alloy	H-331 Carbon	A-331 Alloy		A	B	C	D	E	F	G	H	K	L	N	P	R	T
1/4	1027383	1027524	1950	2750	.55	1.06	.32	.29	2.75	.94	1.19	.81	.88	.50	3.95	2.13	.31	2.58	.81
5/16	1027409	1027542	2875	4300	.79	1.22	.43	.34	3.06	1.06	1.25	.94	1.00	.56	4.52	2.25	.38	2.87	.97
3/8	1027427	1027560	4000	5250	1.21	1.38	.45	.44	3.63	1.31	1.50	1.13	1.19	.66	5.15	2.56	.44	3.25	1.06
7/16	1027445	1027588	5000	7000	2.06	1.73	.59	.60	4.34	1.56	1.81	1.38	1.44	.81	5.97	3.06	.56	3.70	1.19
1/2	1027463	1027604	6500	9000	2.75	1.88	.57	.53	4.81	1.69	1.94	1.56	1.63	.91	6.53	3.44	.63	4.00	1.31
5/8	1027481	1027622	9250	13500	4.75	2.31	.71	.71	5.63	2.00	2.38	1.81	1.94	1.09	7.89	4.00	.75	4.94	1.56
3/4	-	1027640	-	19250	11.28	3.19	1.18	1.29	7.38	2.50	3.00	2.38	2.50	1.44	10.02	5.06	1.00	6.09	2.09

* Ultimate Load is 4 times the Working Load Limit.

H-324



- Forged Carbon Steel - Quenched and Tempered.
- **Not Suitable for use with Grade 80 chain and chain slings used in overhead lifting.** For slings or lifting chains, Grade 80 or 100 alloy components are recommended.

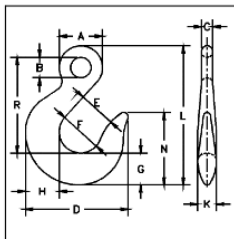

H-324 Eye Slip Hooks

Chain Size (in.)	H-324 Stock No.	Working Load Limit (lbs.)*	Weight Each (lbs.)	Dimensions (in.)												
				A	B	C	D	E	F	G	H	K	L	N	R	
1/4	1026749	1950	.40	1.06	.50	.28	2.75	.94	1.19	.81	.88	.50	3.66	2.13	2.56	
5/16	1026767	2875	.64	1.25	.63	.34	3.06	1.06	1.25	.94	1.00	.56	4.23	2.25	2.95	
3/8	1026785	4000	1.10	1.53	.72	.41	3.63	1.31	1.50	1.13	1.19	.66	4.89	2.56	3.36	
7/16	1026801	5000	1.56	1.69	.81	.44	4.34	1.56	1.81	1.38	1.44	.81	5.70	3.06	3.88	
1/2	1026829	6500	2.09	1.94	.94	.50	4.81	1.69	1.94	1.56	1.63	.91	6.34	3.44	4.28	
5/8	1026847	9250	3.90	2.38	1.13	.63	5.63	2.00	2.38	1.81	1.94	1.09	7.66	4.00	5.22	
3/4	1026865	12500	6.93	2.88	1.38	.75	6.75	2.13	2.75	2.19	2.31	1.31	8.73	4.75	5.80	

* Ultimate Load is 4 times the Working Load Limit.

WARNING: DO NOT EXCEED RATED CAPACITIES