

THE JAMES WALKER CO.

CHAIN ATTACHMENTS & ACCESSORIES (NOT FOR OVERHEAD LIFTING)

Quick Links



Bulk Cartons - unit of order - piece

Trade Size	Weight Per Piece	WLL Lbs.	Pieces Per Master	Zinc Stock No.
1/8"	0.02	220	20	8056035
3/16"	0.05	616	20	8056135
1/4"	0.08	800	20	8056235
5/16"	0.18	1540	20	8056335
3/8"	0.24	1900	10	8056435
1/2"	0.53	2650	10	8056635

Spring Links



Bulk Cartons - unit of order - piece

Trade Size	Weight Per Piece	WLL Lbs.	Pieces Per Master	Zinc Stock No.
6mm	0.08	175	20	4410440
7mm	0.11	225	20	4410640
8mm	0.16	350	20	4410240
9mm	0.23	400	10	4426040
10mm	0.32	425	10	4425240
11mm	0.45	750	10	4426140

Cold Shuts

Bulk Cartons, Self Colored & Zinc - unit of order - piece

Trade Size	Weight Per Piece	WLL Lbs.	Pieces Per Master	Self Colored Stock No.	Zinc Stock No.
3/16"	0.03	390	25	8040115	8040135
1/4"	0.05	750	25	8040215	8040235
5/16"	0.10	1250	25	8040315	8040335
3/8"	0.17	1630	25	8040415	8040435
1/2"	0.39	3500	25	8040615	8040635



ACCOLOY "S" HOOKS

Alloy "S" Hooks for use on overhead parts painting and processing conveyor systems and many other material handling requirements. Working Load Limit and "A", indicating alloy steel, are stamped on each hook. Custom sizes are available upon request.

Specifications

Stock Number	Size Inches	WLL Lbs.	Wt. Each Lbs.	Dimensions			
				D	B	T	C
593300600	3/8	430	.28	3/8"	4-1/8"	1-1/8"	1-1/8"
593300800	1/2	770	.63	1/2"	5-1/2"	1-1/2"	1-1/2"
593301000	5/8	1,200	1.3	5/8"	7"	1-7/8"	1-7/8"
593301200	3/4	1,700	2.1	3/4"	8-1/4"	2-1/4"	2-1/4"
593301400	7/8	2,300	3.4	7/8"	9-5/8"	2-5/8"	2-5/8"

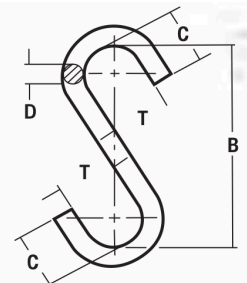

WARNING: DO NOT EXCEED RATED CAPACITIES