

THE JAMES WALKER CO.

CROSBY ALLOY SCREW PIN SHACKLES

Load Rated

G-209A



Screw pin anchor shackles meet the performance requirements of Federal Specification RR-C-271D Type IVA, Grade B, Class 2, except for those provisions required of the contractor. For additional information, see page 391.

- Capacities 2 thru 21 metric tons.
- Forged Alloy Steel - Quenched and Tempered, with alloy pins.
- Working Load Limit permanently shown on every shackle.
- Hot Dip Galvanized.
- Crosby products meet or exceed all requirements of ASME B30.26 including identification, ductility, design factor, proof load and temperature requirements. Importantly, Crosby products meet other critical performance requirements including fatigue life, impact properties and material traceability, not addressed by ASME B30.26.
- Shackles can be furnished proof tested with certificates to designated standards, such as ABS, DNV, Lloyds, or other certification. Charges for proof testing and certification available when requested at the time of order.

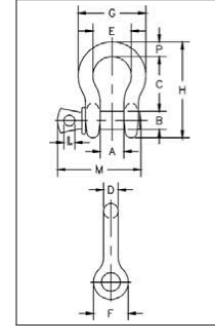

G-209A

Crosby® Alloy Screw Pin Shackles

Nominal Size (in.)	Working Load Limit (t)*	G-209-A Stock No.	Weight Each (lbs.)	Dimensions (in.)												Tolerance +/-	
				A	B	C	D	E	F	G	H	L	M	P	C	A	
3/8	2	1017450	.31	.66	.44	1.44	.38	1.03	.91	1.78	2.49	.25	2.03	.38	.13	.06	
7/16	2-2/3	1017472	.38	.75	.50	1.69	.44	1.16	1.06	2.03	2.91	.31	2.38	.44	.13	.06	
1/2	3-1/3	1017494	.63	.81	.63	1.88	.50	1.31	1.19	2.31	3.28	.38	2.69	.50	.13	.06	
5/8	5	1017516	1.38	1.06	.75	2.38	.63	1.69	1.50	2.94	4.19	.44	3.34	.69	.13	.06	
3/4	7	1017538	2.25	1.25	.88	2.81	.75	2.00	1.81	3.50	4.97	.50	3.97	.81	.25	.06	
7/8	9-1/2	1017560	3.61	1.44	1.00	3.31	.88	2.28	2.09	4.03	5.83	.50	4.50	.97	.25	.06	
1	12-1/2	1017582	5.32	1.69	1.13	3.75	1.00	2.69	2.38	4.69	6.56	.56	5.07	1.06	.25	.06	
1-1/8	15	1017604	7.25	1.81	1.25	4.25	1.16	2.91	2.69	5.16	7.47	.63	5.59	1.25	.25	.06	
1-1/4	18	1017626	9.88	2.03	1.38	4.69	1.29	3.25	3.00	5.75	8.25	.69	6.16	1.38	.25	.06	
1-3/8	21	1017648	13.25	2.25	1.50	5.25	1.42	3.63	3.31	6.38	9.16	.75	6.84	1.50	.25	.13	

* Maximum Proof Load is 2 times the Working Load Limit (metric tons) and 2.2 times the Working Load Limit (short tons). Minimum Ultimate Strength is 4.5 times the Working Load Limit for metric tonnes, and 5 times the Working Load Limit for short tons. For Working Load Limit reduction due to side loading applications, see page 74.

G-209R ROV SHACKLES



- Capacities from 6-1/2t through 55t.
- Forged Steel, Quenched & Tempered, with alloy pins.
- Working Load Limit permanently shown on every shackle.
- Fatigue rated.
- QUIC-CHECK® deformation and angle indicators forged on the bow.
- All ROV shackle bows, unless otherwise noted, are galvanized, then painted fluorescent yellow.
- Look for the Red Pin® ... the mark of genuine Crosby quality.

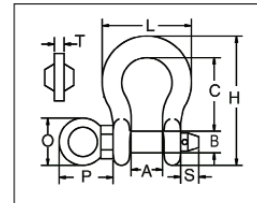

G-209R ROV Shackles

Working Load Limit (t)*	G-209R Stock No.	Weight Each (lbs.)	Dimensions (in.)								
			A +/- .25	B	C	H	L	O	P	S	T
6-1/2	1020872	3.62	1.44	1.00	3.31	5.83	4.03	1.18	2.28	.65	.39
8-1/2	1020902	5.03	1.69	1.13	3.75	6.56	4.69	1.18	2.40	.73	.39
9-1/2	1020932	7.41	1.81	1.25	4.25	7.47	5.16	2.28	3.27	.75	.47
12	1020952	9.50	2.03	1.38	4.69	8.25	5.75	2.28	3.31	.89	.47
13-1/2	1020972	13.53	2.25	1.50	5.25	9.16	6.38	2.36	3.58	.91	.59
17	1020992	17.20	2.38	1.63	5.75	10.00	6.88	2.36	3.66	1.18	.59
†25	1021102	27.78	2.88	2.00	7.00	12.34	8.86	2.16	4.49	1.14	.69
†35	1021125	45.00	3.25	2.25	7.75	13.68	9.97	2.60	5.12	1.18	.79
†55	1021158	85.75	4.13	2.75	10.50	17.84	12.87	2.76	5.63	1.50	.98

* Minimum Ultimate Load is 5 times the Working Load Limit.
 † Furnished with Galvanized Finish.

WARNING: DO NOT EXCEED RATED CAPACITIES