

THE JAMES WALKER CO.

CROSBY FORGED EYE NUTS

G-400



- Forged Steel - Quenched and Tempered.
- Hot Dip galvanized.
- Tapped with standard UNC class 2 threads after galvanizing.
- Crosby products meet or exceed all requirements of ASME B30.26 including identification, ductility, design factor, proof load and temperature requirements. Importantly, Crosby products meet other critical performance requirements including fatigue life, impact properties and material traceability, not addressed by ASME B30.26.
- Also available in blank (as forged) item (S-4028) or on request with metric threading (M-400).

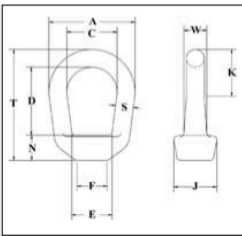

G-400 Eye Nuts

Size No.	"S" Stock Size (in.)	G-400 Stock No.	Std. Tap Size	Working Load Limit (lbs.)*	Weight Each (lbs.)	Dimensions (in.)										
						A	C	D	E	F	J	K	N	T	W	
1	.25	1090438	1/4	520	.09	1.25	.75	1.00	.75	.50	.69	.63	.46	1.72	.31	
2	.31	1090474	3/8	1250	.17	1.62	1.00	1.20	.83	.56	.81	.89	.58	2.09	.41	
3A	.38	1090517	1/2	2250	.28	2.00	1.25	1.44	1.08	.81	1.00	1.09	.73	2.55	.50	
4	.50	1090535	5/8	3600	.60	2.50	1.50	1.92	1.35	1.00	1.31	1.31	.83	3.25	.69	
5	.63	1090553	3/4	5200	1.00	3.00	1.75	2.28	1.59	1.12	1.50	1.57	1.05	3.96	.84	
6	.75	1090571	7/8	7200	1.65	3.50	2.00	2.50	1.96	1.38	1.88	1.77	1.14	4.40	1.00	
7	.88	1090599	1	10000	2.69	4.00	2.25	2.92	2.21	1.56	2.13	2.02	1.30	5.10	1.19	
8	1.00	1090633	1-1/4	15500	4.38	4.50	2.50	3.35	2.46	1.88	2.38	2.27	1.52	5.87	1.38	
9	1.13	1090651	1-3/8	18500	5.00	5.00	2.75	4.00	2.69	2.00	2.56	2.53	1.67	6.51	1.50	
10	1.25	1090679	1-1/2	22500	6.78	5.62	3.12	4.31	3.09	2.25	3.00	2.82	1.83	7.06	1.66	
11	1.50	1090697	2	40000	14.60	7.12	4.10	6.00	4.09	3.13	3.75	3.68	2.49	10.13	1.94	

* Ultimate Load is 5 times the Working Load Limit. Rating based on standard tap size.

S-265



- Forged Steel — Quenched and Tempered.
- Forged from 1035 Carbon Steel.
- Excellent welding qualities.
- Reference American Welding Society specifications for proper welding procedures.

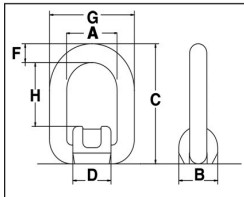

S-265 Weld-On Pivot Link

Design Factor 5:1	Design Factor 4:1	S-265 Stock No.	Weight Each (lbs.)	Dimensions (in.)							Minimum Fillet Weld Size (in.)
				A	B	C	D	F	G	H	
1	1.2	1290740	.88	1.57	1.42	3.27	1.38	.51	2.60	1.65	3/32
2.5	3.2	1290768	1.32	1.77	1.73	3.90	1.65	.71	3.19	1.89	3/32
4	5.3	1290786	2.65	2.17	1.97	4.84	1.93	.87	3.90	2.24	1/4
6.4	8	1290802	5.29	2.76	2.52	5.67	2.52	1.02	4.80	2.64	1/4
12	15	1290820	13.01	3.82	3.54	7.60	3.39	1.34	6.50	3.70	5/16

WARNING: DO NOT EXCEED RATED CAPACITIES