

# THE JAMES WALKER CO.

## BLOCKS

### FULLY RATED INTERMEDIATE BLOCKS SWIVEL EYE AND SWIVEL HOOK TYPES

#### 0183

##### Fully Rated Intermediate Block with Swivel Eye

Heavy gauge stamped steel cheeks. Drop forged swivel eyes. Machined carbon steel sheaves. Oil impregnated bronze bushings.

10 pack and bulk pack.  
\*\*5 pack and bulk pack.

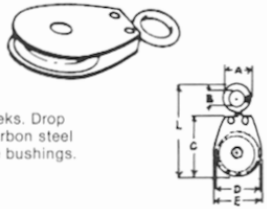

Size	1 1/2	2	2 1/2	3**	3 1/2**
For Diam. Rope, inches	3/16	3/16	1/4	5/16	3/8
Dimensional Data, inches					
A	1 1/4	1 1/4	1 1/2	1 5/8	2
B	5/8	5/8	7/8	1	1 1/8
C	2 1 1/32	2 27/32	3 7/16	4 2 1/64	5 3/64
D	1 1/2	2	2 1/2	3	3 1/2
E	1 1 1/16	2 5/32	2 1 1/16	3 7/32	3 3 3/16
L	3 27/32	4 1 1/32	5 3/16	6 9/64	7 3 3/64
Working Load, lbs.	420	480	550	640	1240
Weight per 100, lbs.	53	77	107	234	319

Working loads have been determined at a factor of 4-1.

#### 0184

##### Fully Rated Intermediate Block with Swivel Hook and Keeper

Heavy gauge stamped steel cheeks. Drop forged swivel hooks. Machined carbon steel sheaves. Oil impregnated bronze bushings.

10 pack and bulk pack.  
\*\*5 pack and bulk pack.

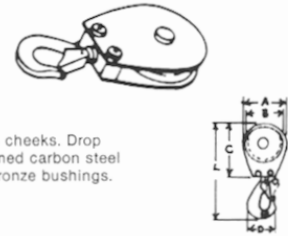

Size	1 1/2	2	2 1/2	3**	3 1/2**
For Diam. Rope, inches	3/16	3/16	1/4	5/16	3/8
Dimensional Data, inches					
A	1 1 1/16	2 5/32	2 1 1/16	3 7/32	3 13/16
B	1 1/2	2	2 1/2	3	3 1/2
C	2 1 1/32	2 27/32	3 7/16	4 2 1/64	5 3/64
D	1 2 9/64	1 3/4	1 3/4	1 3/4	2 3/8
L	4 1 5/32	5 1/2	6 1/8	7	8 5/8
O Diam. Rod	7/16	9/16	9/16	9/16	3/4
Working Load, lbs.	420	480	550	640	1240
Weight per 100, lbs.	56	92	119	250	335

Working loads have been determined at a factor of 4-1.

## REPLACEMENT SHEAVES

#### 0183B

##### Sheave

Cadmium plated machined carbon steel. Corrosion-resistant oil-impregnated bronze bushings.

10 pack.

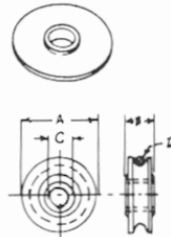

A Sheave Diam., inches	1 1/2	2	2 1/2	3	3 1/2
D Wire Rope Diam., inches	3/16	3/16	1/4	5/16	3/8
C Bushing I.D., inches	1/2	1/2	1/2	3/4	3/4
B Width of Sheave, inches	1 7/32	1 7/32	1 7/32	2 5/32	2 5/32
Weight per 100, lbs.	21	40	63	135	187

**WARNING: DO NOT EXCEED RATED CAPACITIES**